

REQUEST FOR PROPOSALS (RFP)

Server, SDWAN and Network Infrastructure Refresh

Issued by: Bread for the City

Issue Date: 7/29/2025

Proposal Deadline: 8/8/2025

1. Background

Bread for the City is a Washington, DC-based nonprofit organization providing wraparound direct services—including food, clothing, medical care, legal and social services, and behavioral health—to residents living with low income. Grounded in dignity, equity, and community, our mission is to help Washington, DC residents living with low income to develop their power to determine the future of their own communities. We provide food, clothing, medical care, and legal and social services to reduce the burden of poverty. We seek justice through community organizing and public advocacy. We work to uproot racism, a major cause of poverty. We are committed to treating our clients with the dignity and respect that all people deserve.

Bread for the City seeks a vendor to design and fully deploy a network technology refresh across its two offices. This refresh should upgrade old equipment to modern solutions with extended warranties that will be easy to manage, enhance security and enable scalable growth. This initiative will revitalize the core compute and storage infrastructure that underpins the organization’s virtual servers at its two locations. In addition, the campus wired and wireless networks will be modernized, providing improved connectivity and performance throughout each facility. BFC hopes to upgrade the firewall and SD-WAN solutions, ensuring robust protection against evolving cyber threats while supporting seamless network access across locations and to roughly 40 remote users.

2. Scope of Work

Bread for the City (BFC) seeks a data center and network refresh that includes equipment, warranties, installation and configuration of it's data center, physical and virtual environments, remote connectivity, firewalls, networking hardware, and SD-WAN technology.

Current Infrastructure

BFC is currently utilizing Dell Servers with a VMWare environment, Sonicwall firewalls, a VeloCloud SDWAN solution, and Rukus Wireless system. 40 remote users connect remotely through Sonicwall VPN and Duo 2 factor authentication.

Current Datacenter Environment

Northwest

Compute Servers and Storage

Qty	Model	Description
2	Dell R640	Vmware ESXi Nodes
1	ME4024	Storage Array

Southeast

Compute Servers and Storage

Qty	Model	Description
2	Dell R640	Vmware ESXi Nodes
1	ME4024	Storage Array

# Current Network Environment

## Northwest

### Fixed Port Switches and Wireless

Qty	Model	Description
4	Dell N1524	24 port 1Gbe campus switch
12	Dell N1548P	48 port 1Gbe POE campus switch
7	Ruckus R730	Wireless Access Point
2	Dell S4112F	10Gbe Datacenter Switch

### Firewall and SD-WAN

Qty	Model	Description
2	SonicWall NSA 2650	Firewall
2	Velocloud Edge 600	SD-WAN

## Southeast

### Fixed Port Switches and Wireless

Qty	Model	Description
10	Dell N1548P	48 port 1Gbe POE campus switch
14	Ruckus R730	Wireless Access Point
2	Dell S4112F	10Gbe Datacenter Switch

### Firewall and SD-WAN

Qty	Model	Description
2	SonicWall NSA 2650	Firewall
2	Velocloud Edge 600	SD-WAN

### ***New proposed architecture:***

BFC is interested in moving to a SCALE solution for the Data Center and virtual environment, a CATO solution for SD-WAN, and updated switches and Wireless APs as diagramed below.

Equivalent comparable products will be considered.



# NW Center - 1525 7th St NW

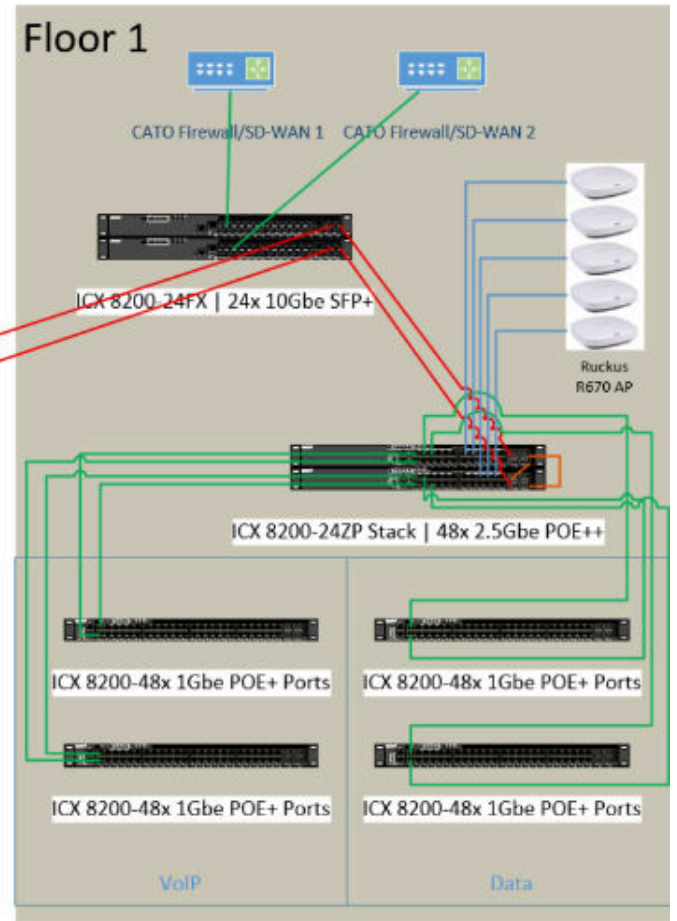
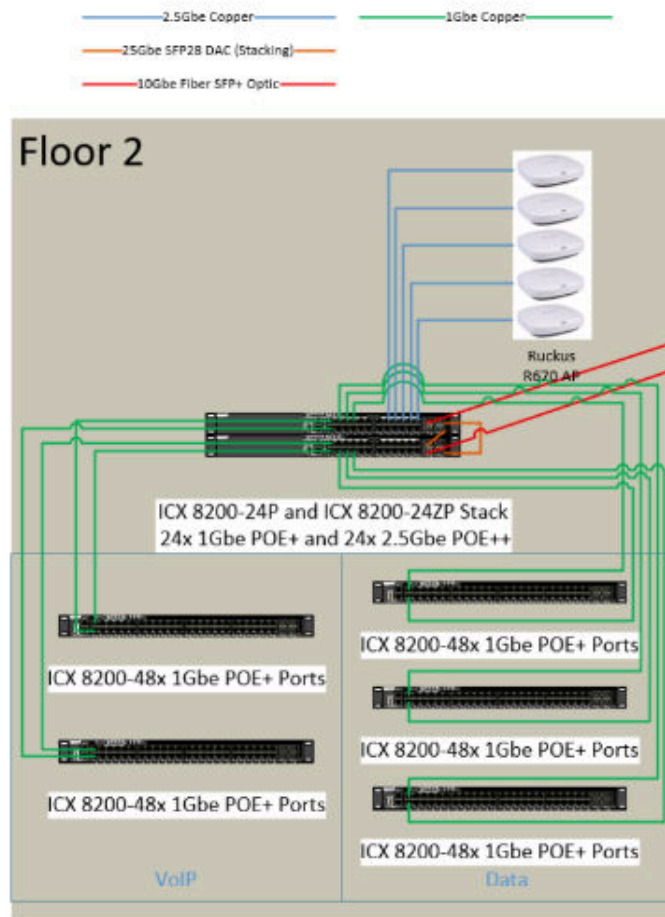

SE Center - 1700 Marion Barry Ave SE

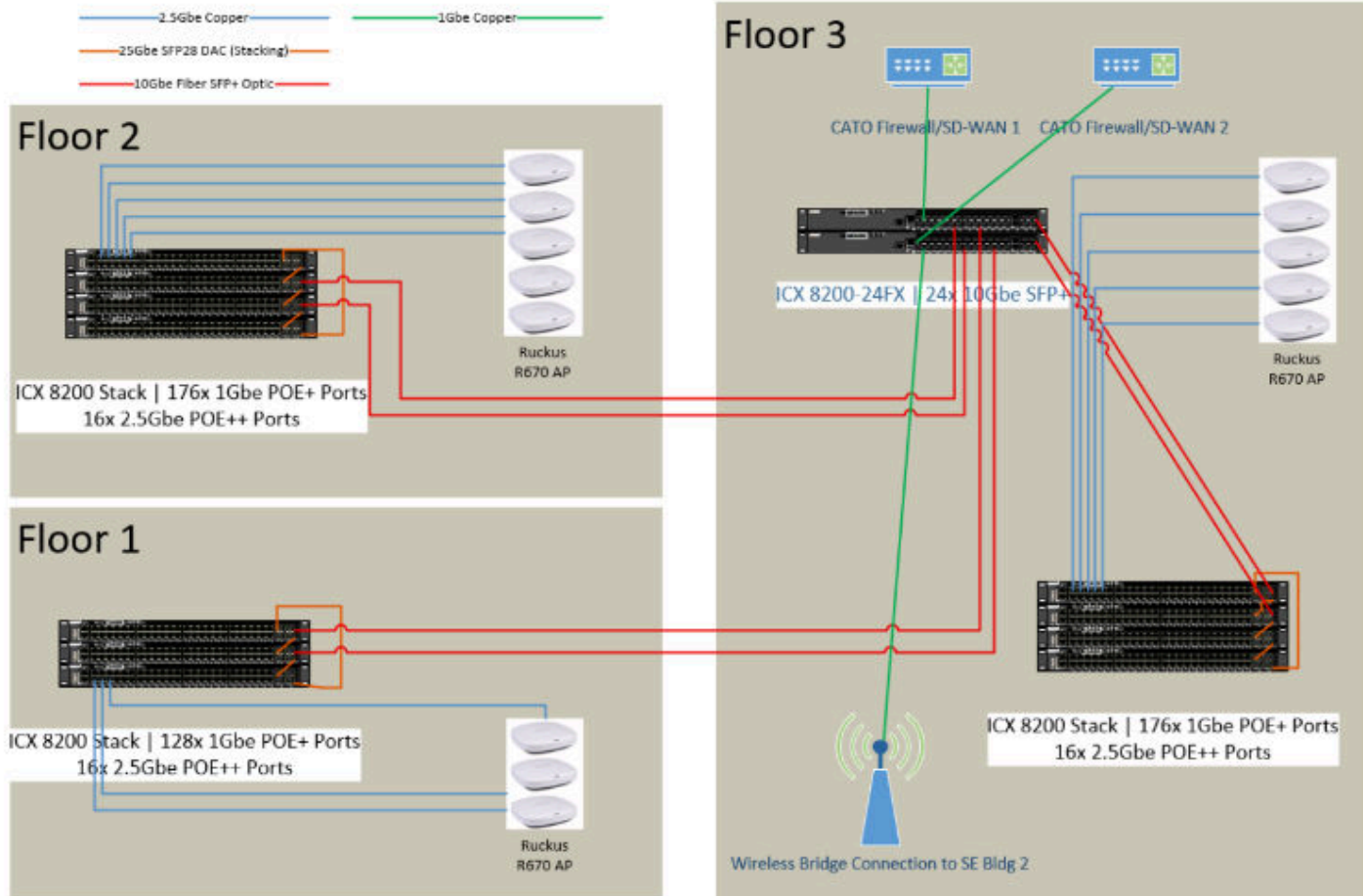

SE 2nd Building - 1640 Marion Barry Ave SE

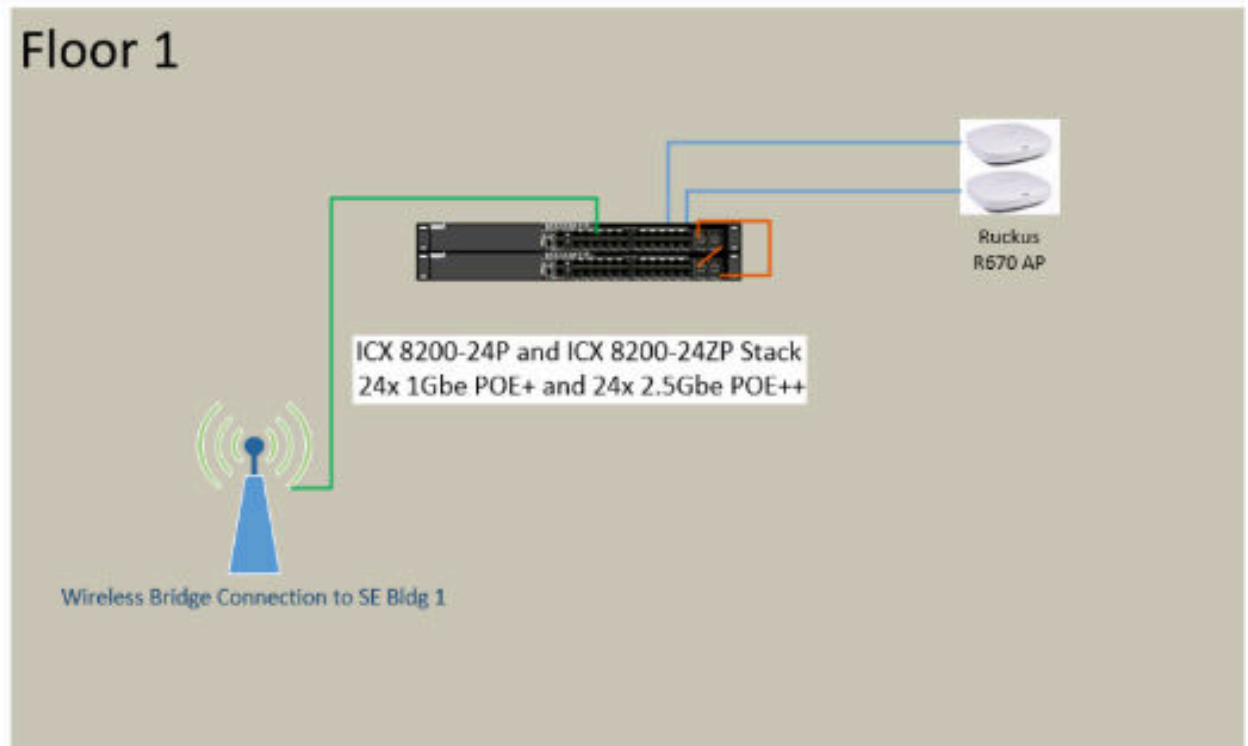

---

### 3. Budget

The total budget for this scope, including equipment, installation, configuration and all up front costs must not exceed \$400,000. Vendors should provide a detailed cost breakdown.

---

### 4. Proposal Requirements

Interested vendors should submit a proposal that includes:

- Agency Overview: Background, mission, core capabilities, and experience with nonprofit clients—especially those in social services.
- Approach: Strategic vision for omnichannel donor engagement, including segmentation, donor journeys, and behavioral science integration.
- Team: Description of the team we would work with.
- References: Contact information for at least three nonprofit clients.
- Budget: Line-item budget for the proposed services.

- Timeline: Project milestones, onboarding schedule, and launch plan.
- 

## 5. Evaluation Criteria

Proposals will be evaluated based on:

- Alignment with budget.
  - Alignment with Bread for the City's values.
  - Demonstrated expertise.
  - Support offerings.
  - Project management capabilities and team strength.
- 

## 6. Timeline

<u>Milestone</u>	<u>Date</u>
RFP Released	July 29, 2025
Questions Due	Aug 1, 2025
Proposals Due	Aug 8, 2025
Vendor Selected	Aug 11, 2025
Project Kickoff	Aug 13, 2025

---

## 7. Submission Instructions

Please email your proposal and any questions to:

Julia Eddy

IT & Data Manager

Bread for the City

[jeddy@breadforthecity.org](mailto:jeddy@breadforthecity.org)

Subject line: **RFP- Server, SDWAN and Network Infrastructure Refresh**

---

Bread for the City is an equal opportunity organization. We strongly encourage applications from organizations led by and serving historically marginalized communities, including Black, Indigenous, and People of Color (BIPOC), LGBTQIA+ communities, immigrants, and people with disabilities.